

Figure B
Floor Framing and Flooring

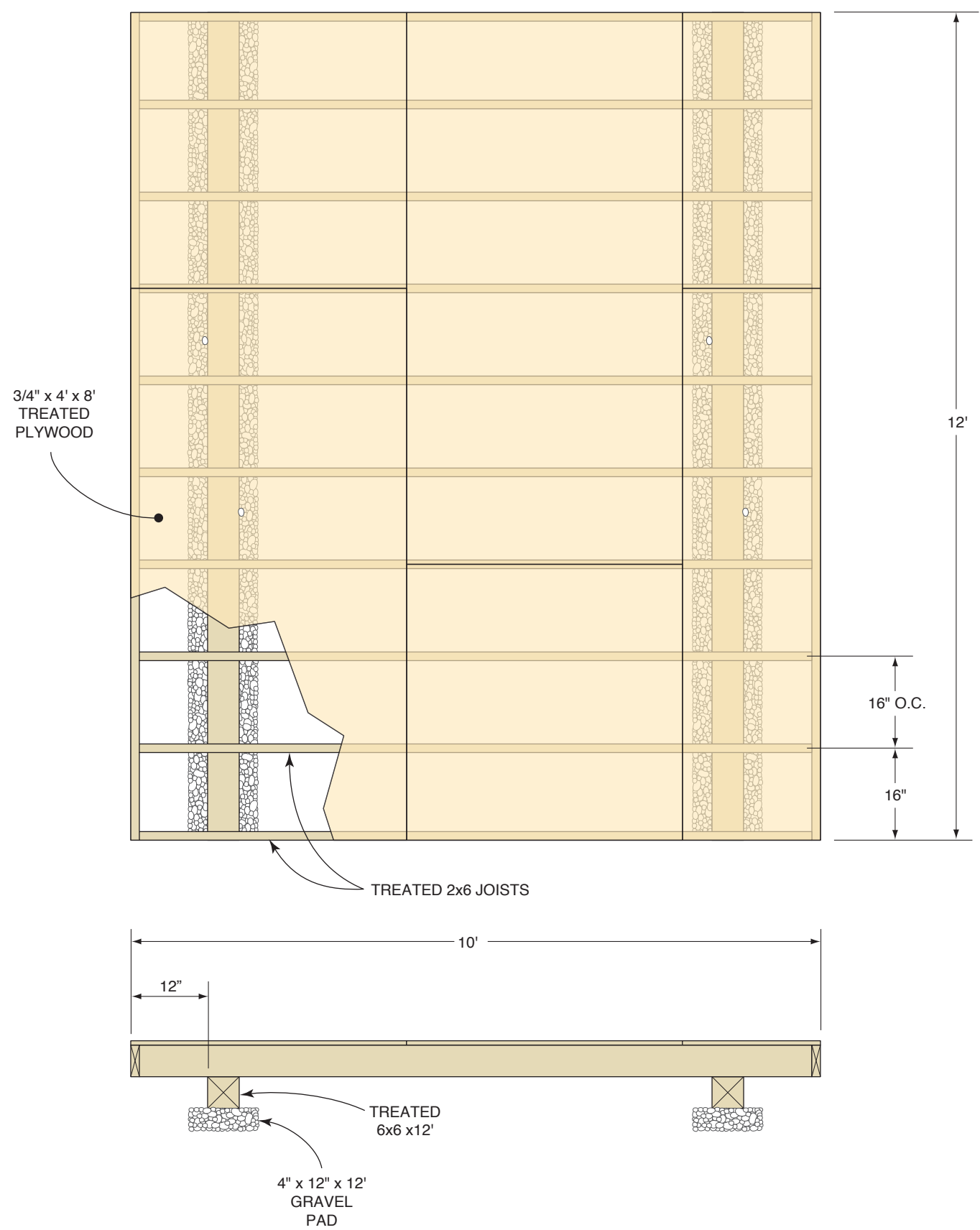

Figure C
Truss Jig

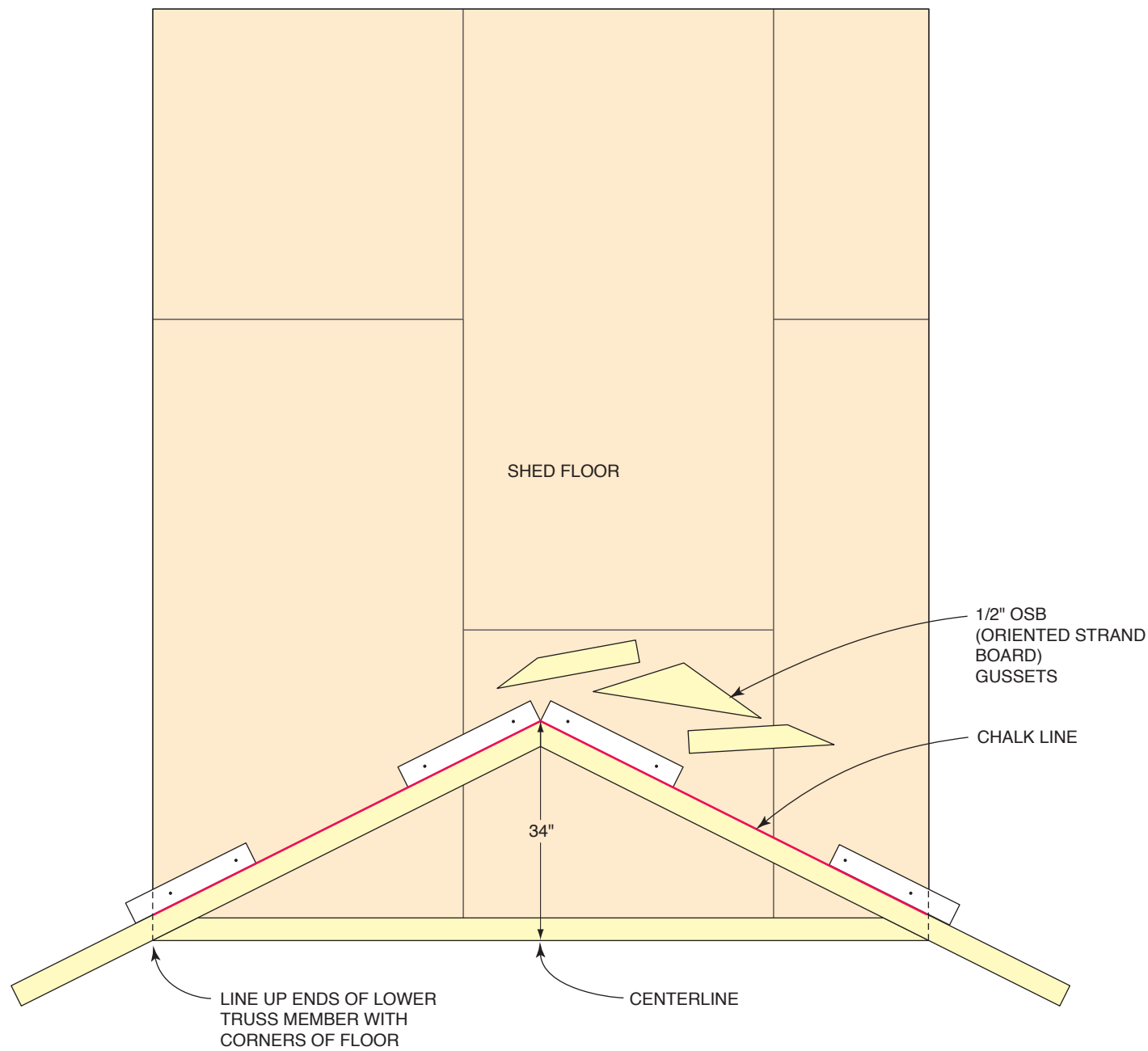
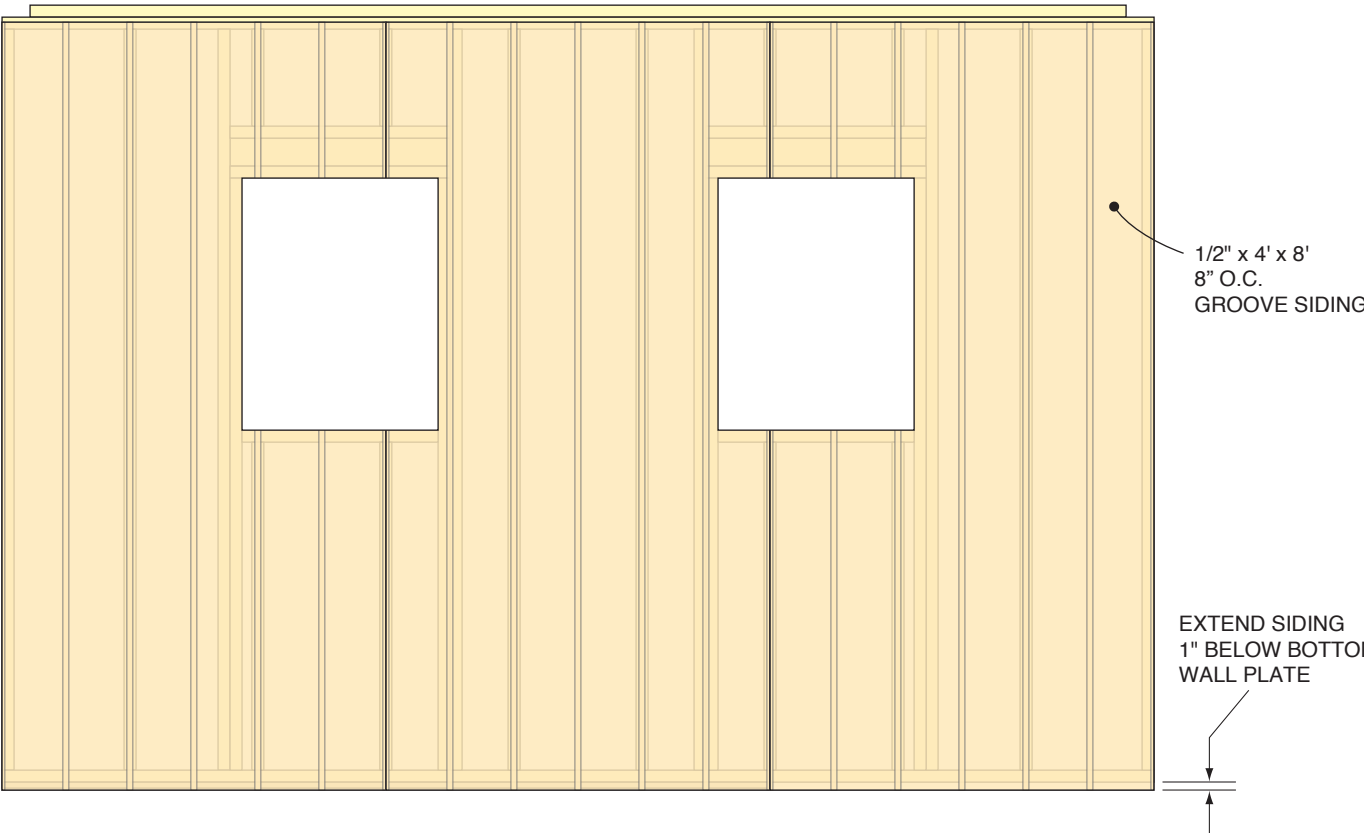
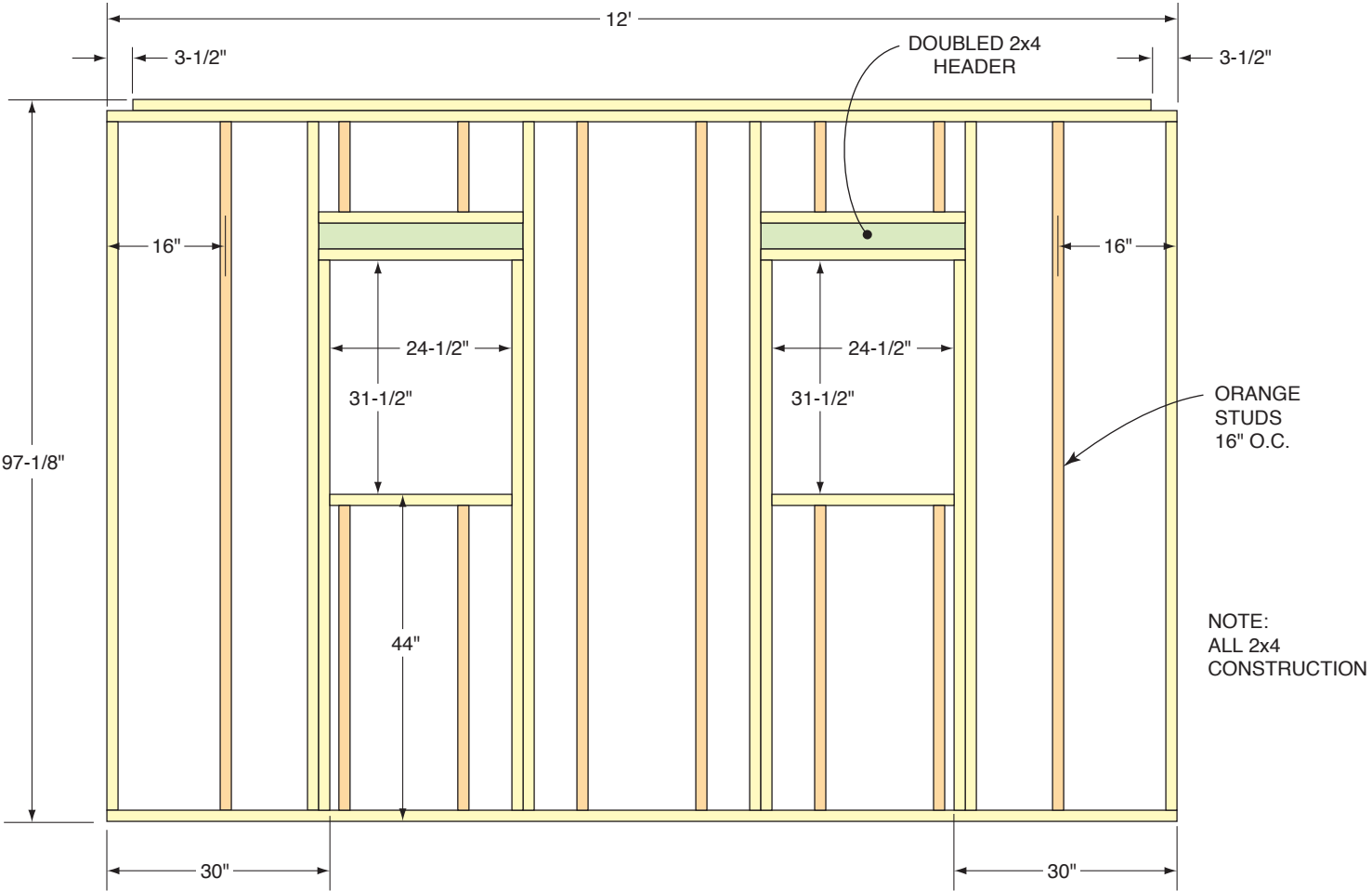

Figure D
Framing and Siding the Side Walls



Front & Rear Walls Framing

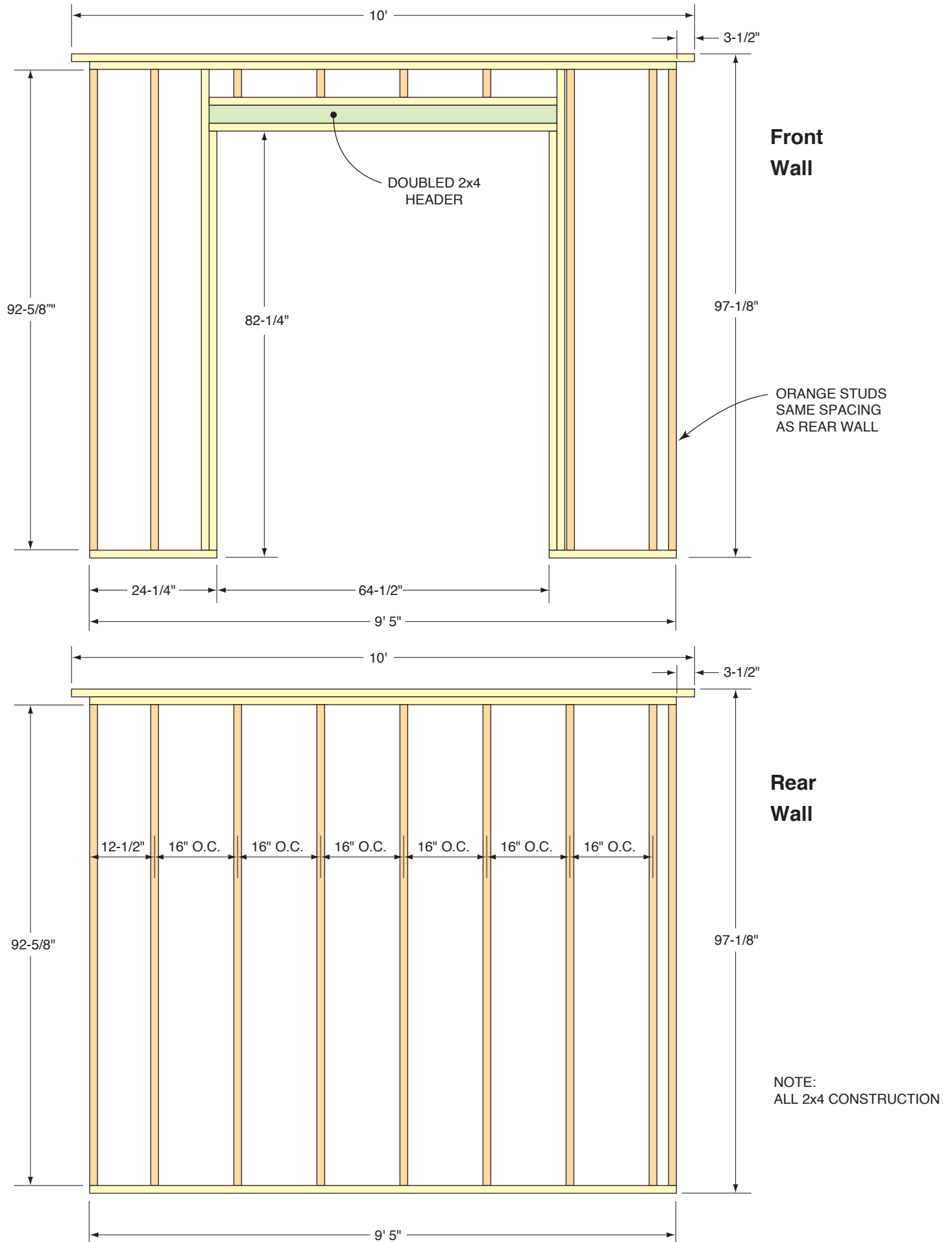

Figure F
Siding the Front
and Rear Walls

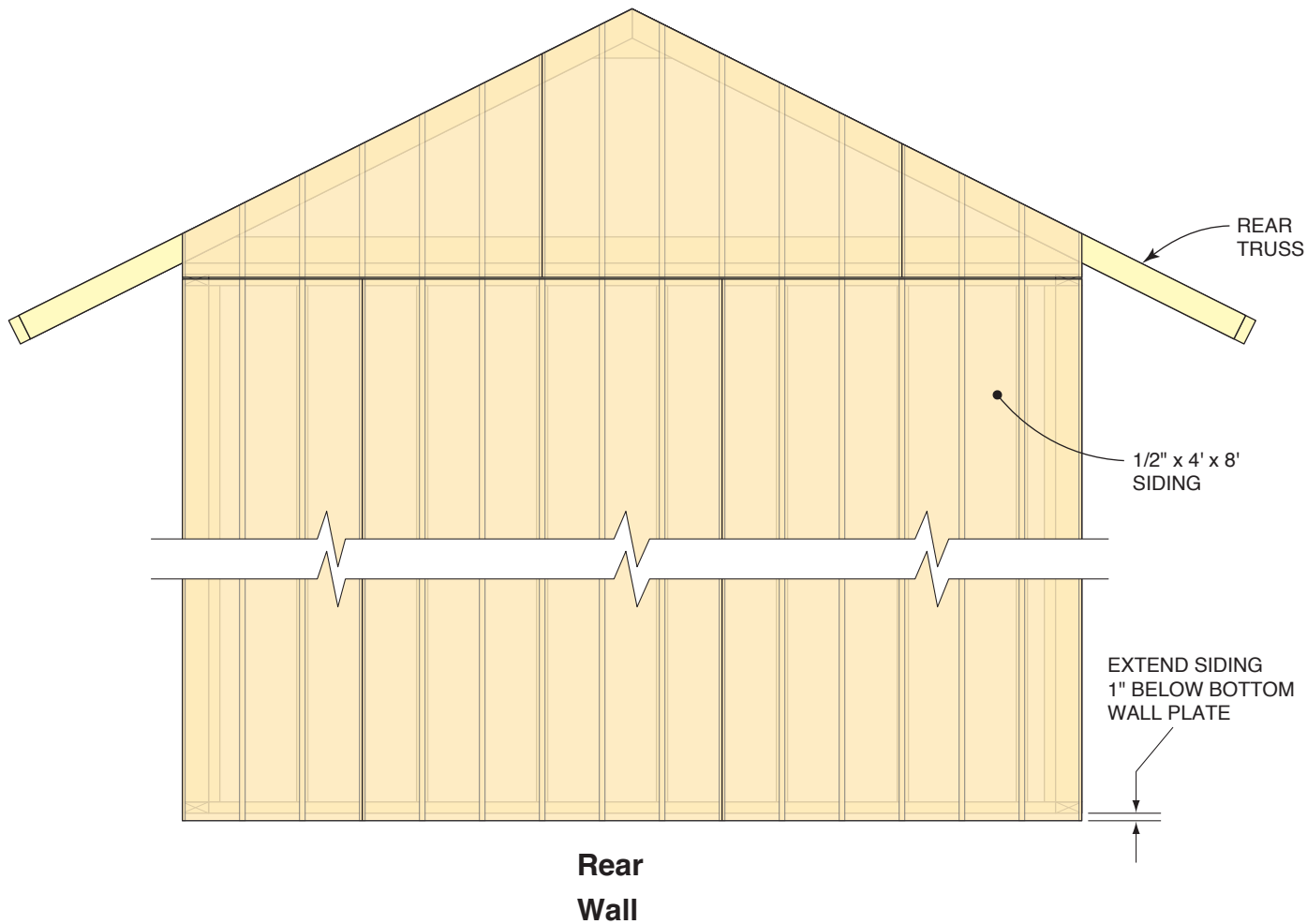
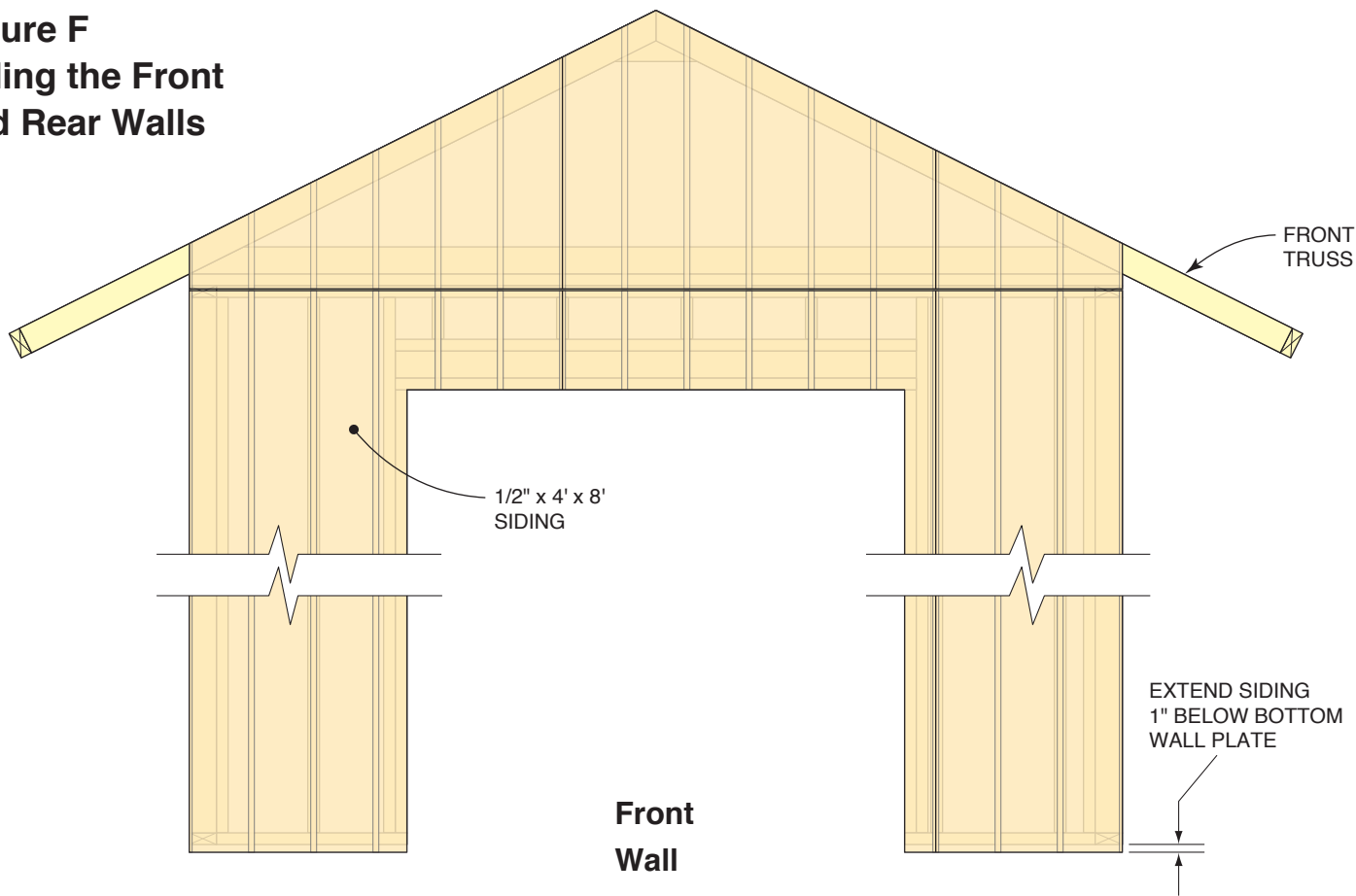
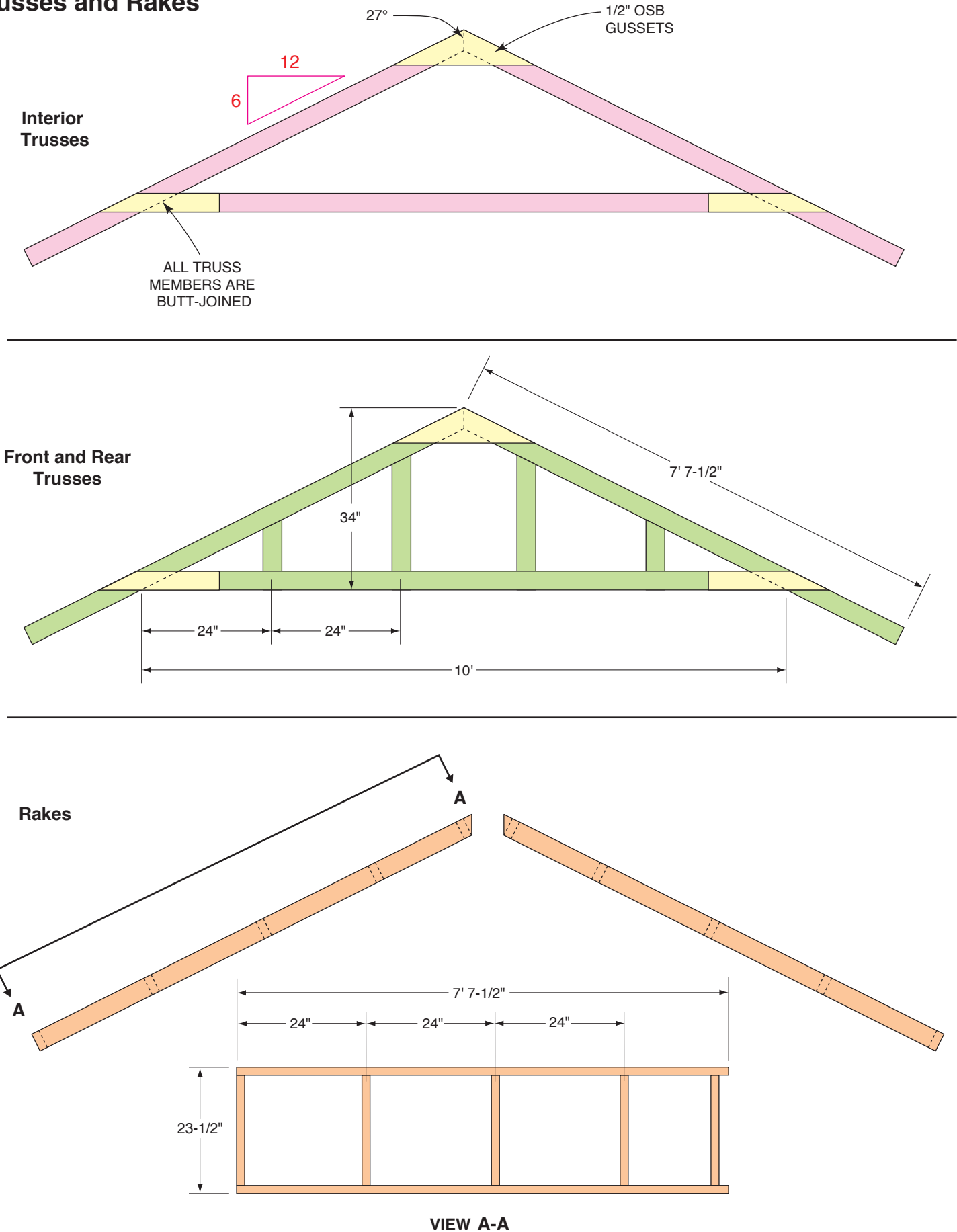
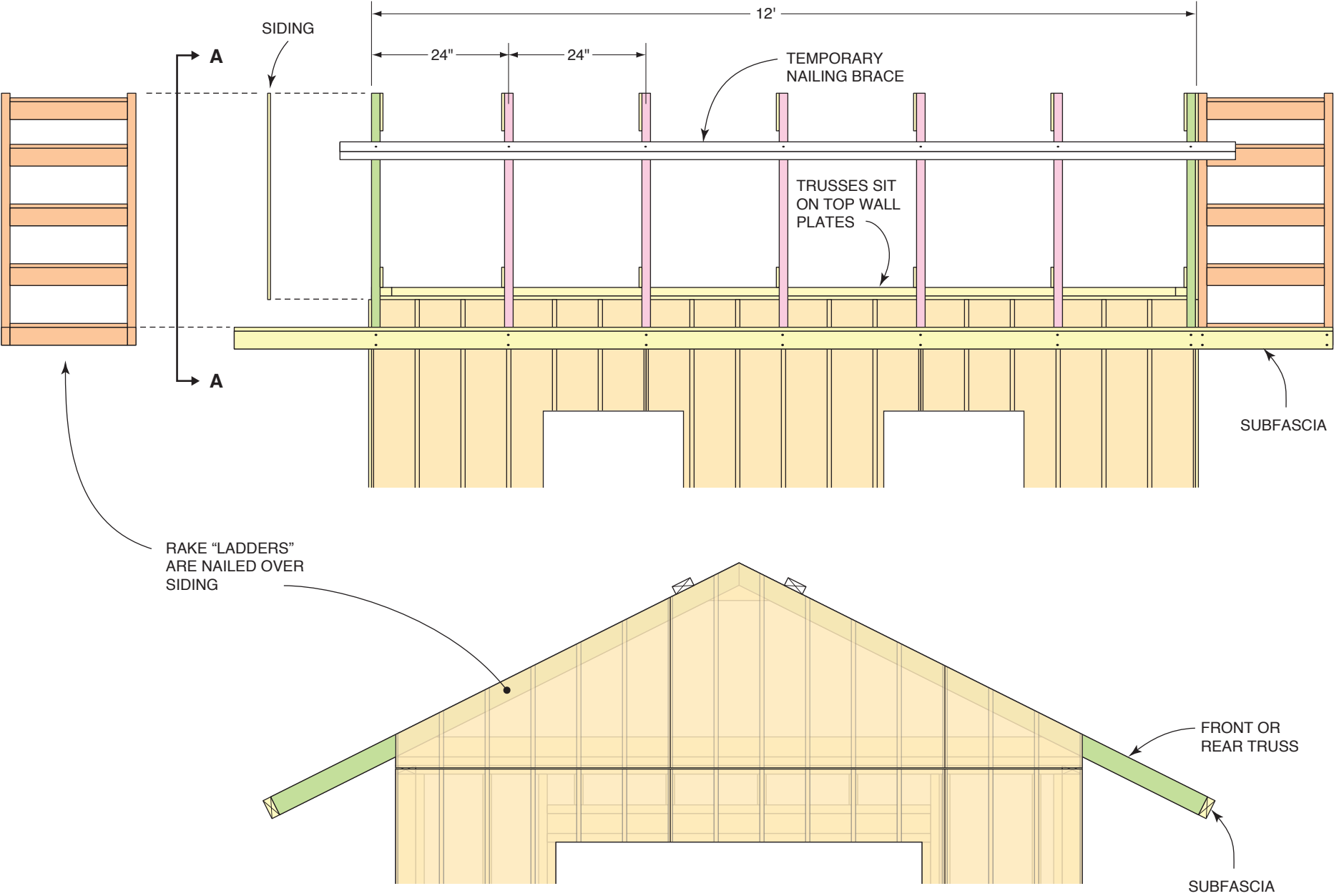

Figure G
Trusses and Rakes



NOTE:
ALL 2x4 CONSTRUCTION
EXCEPT FOR GUSSETS

Figure H
Trusses and Rakes



VIEW A-A

Figure J
Finishing the Front
and Rear Walls

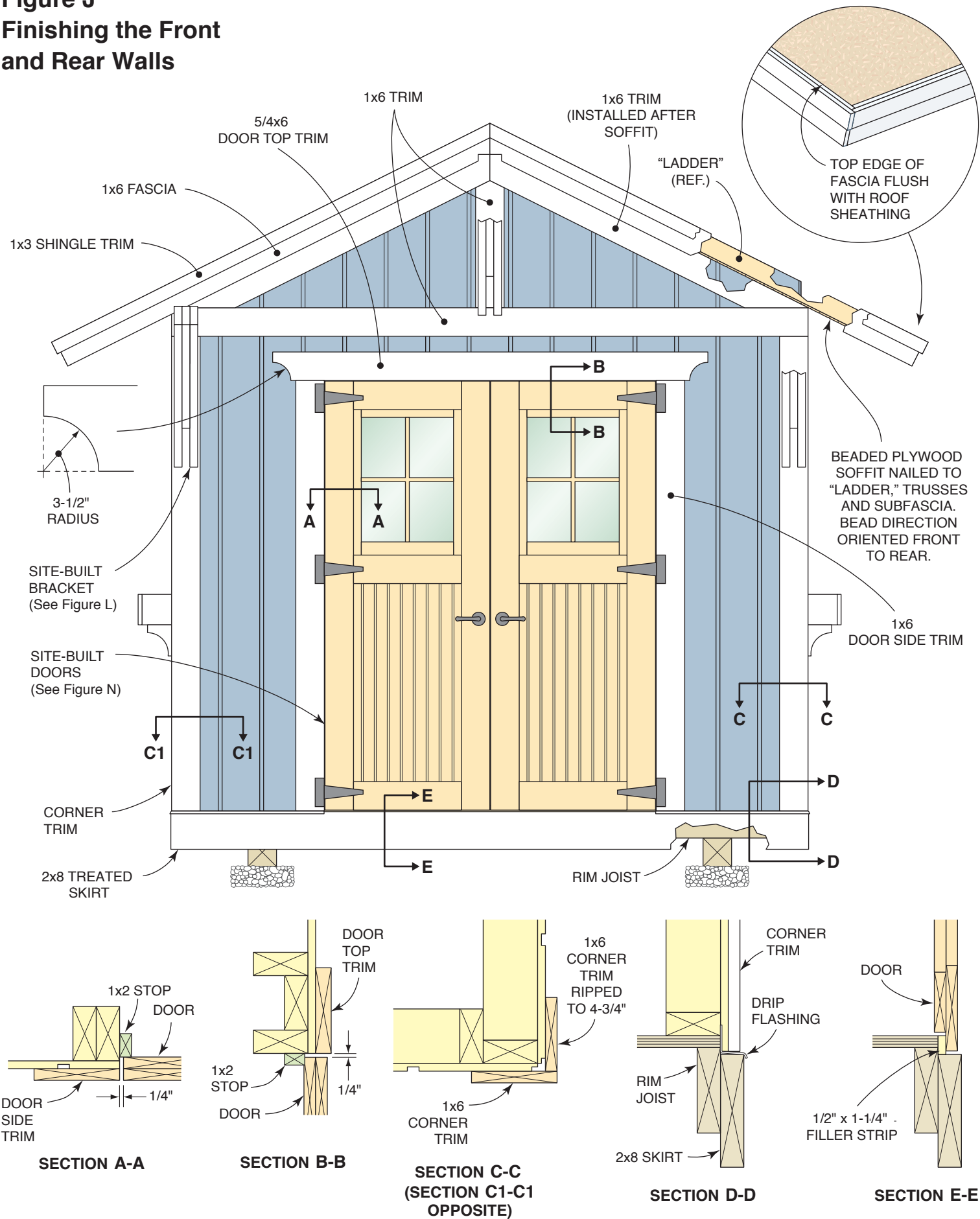

Figure K
Finishing the Side Walls and Roof

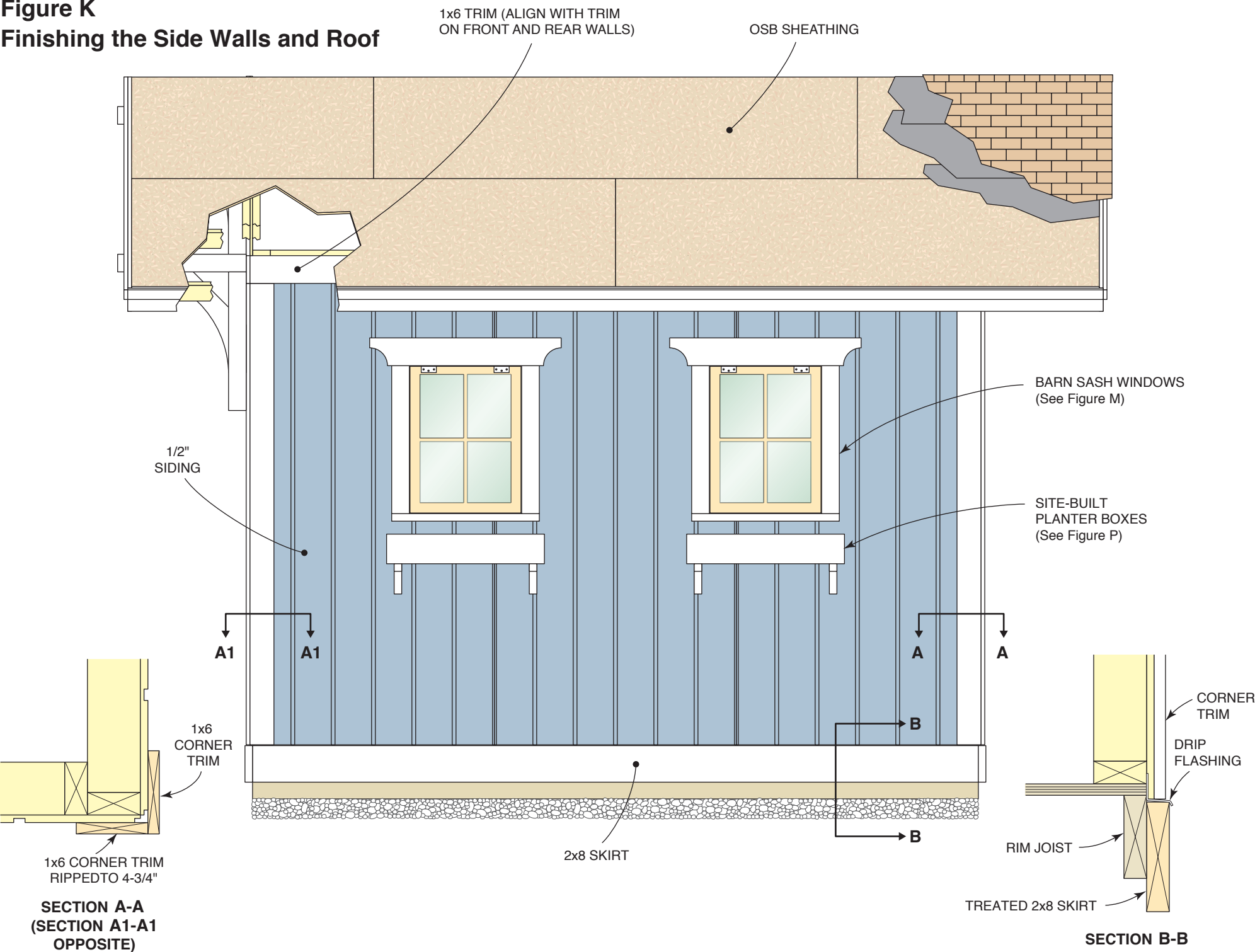

Figure L
Site-Built Bracket

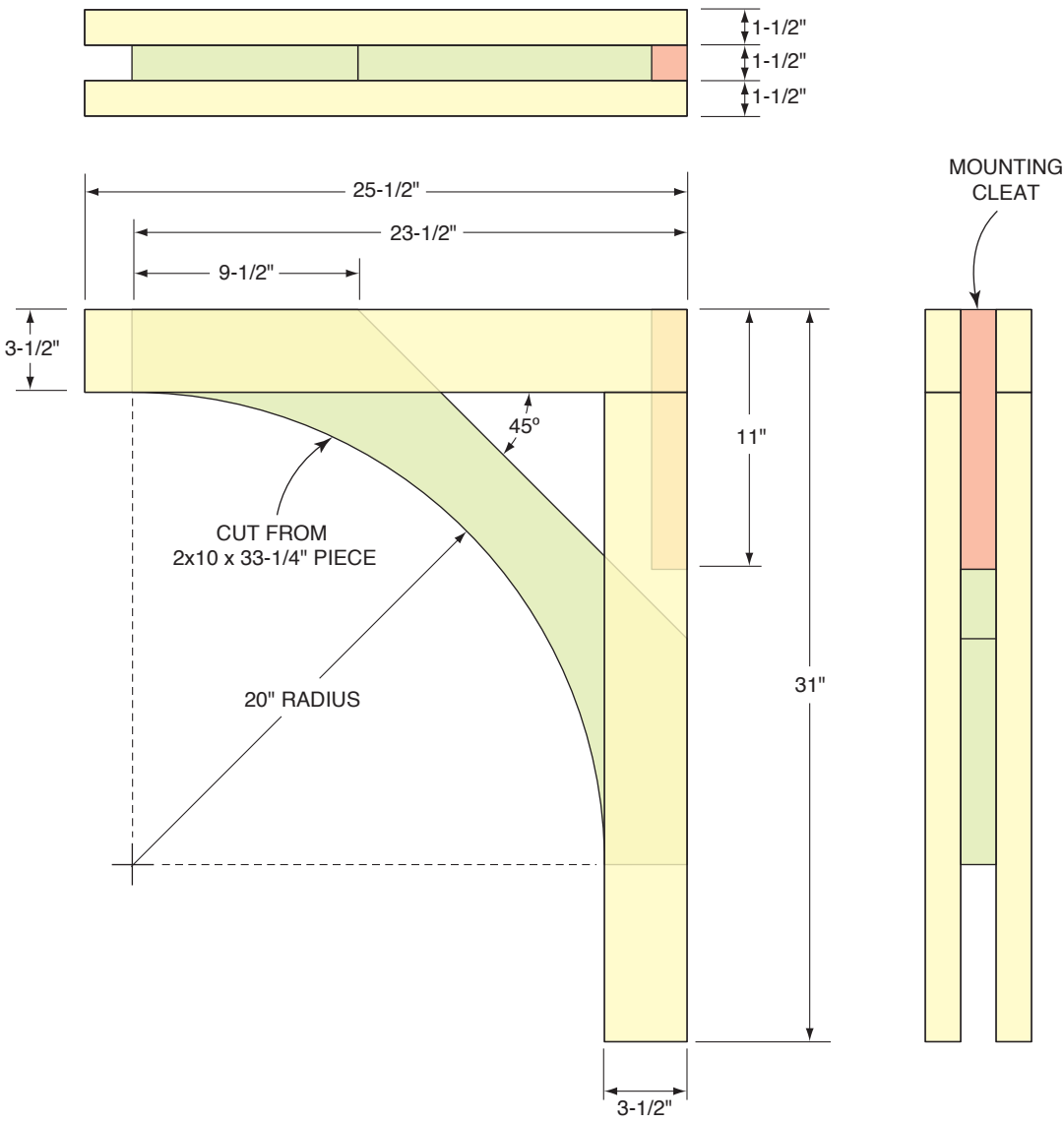

Figure M
Site-Built Window

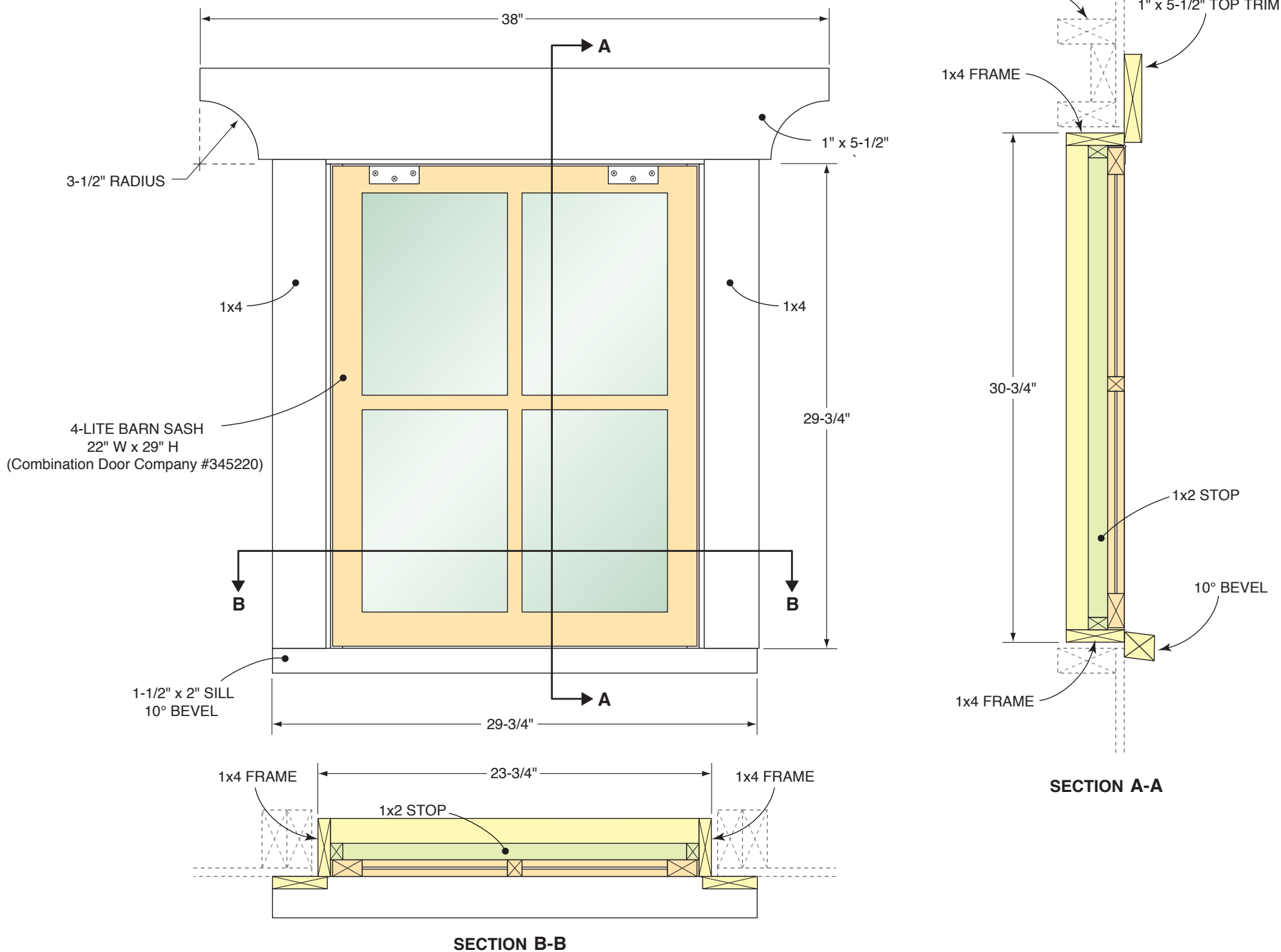
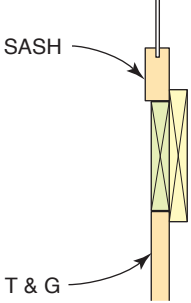
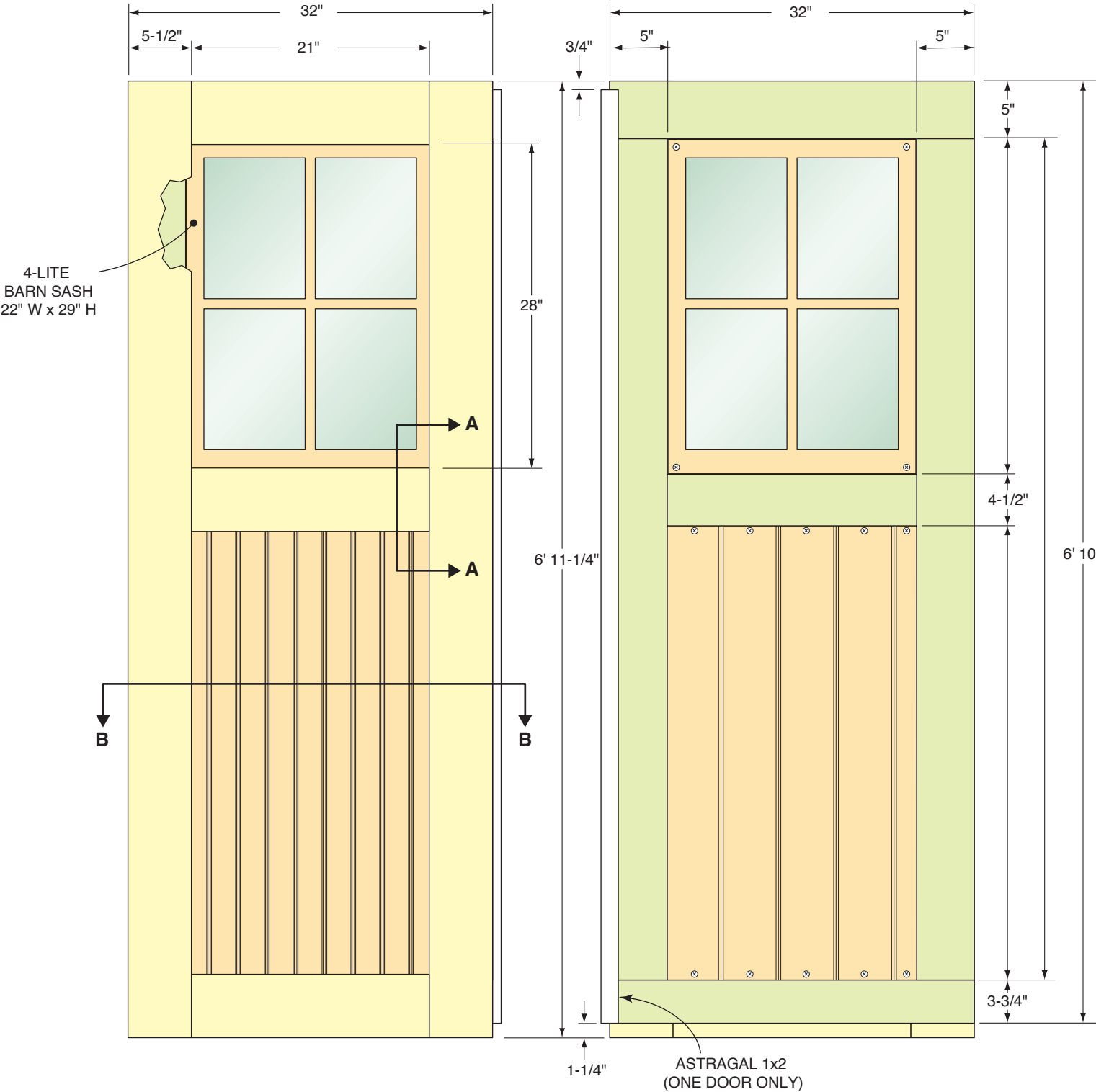

Figure N
Site-Built Door



SECTION A-A

FRONT VIEW

BACK VIEW



SECTION B-B

NOTE: ALL YELLOW PIECES ARE 1x6; ALL GREEN PIECES ARE RIPPED FROM 1x6 WOOD. THE FRAME PIECES ARE POCKET-SCREWED TO FORM FRONT AND REAR FRAMES, WHICH ARE GLUED AS SHOWN. THE POCKET SCREWS ARE ON THE GLUE SIDES.

Figure P
Site-Built Planter Boxes

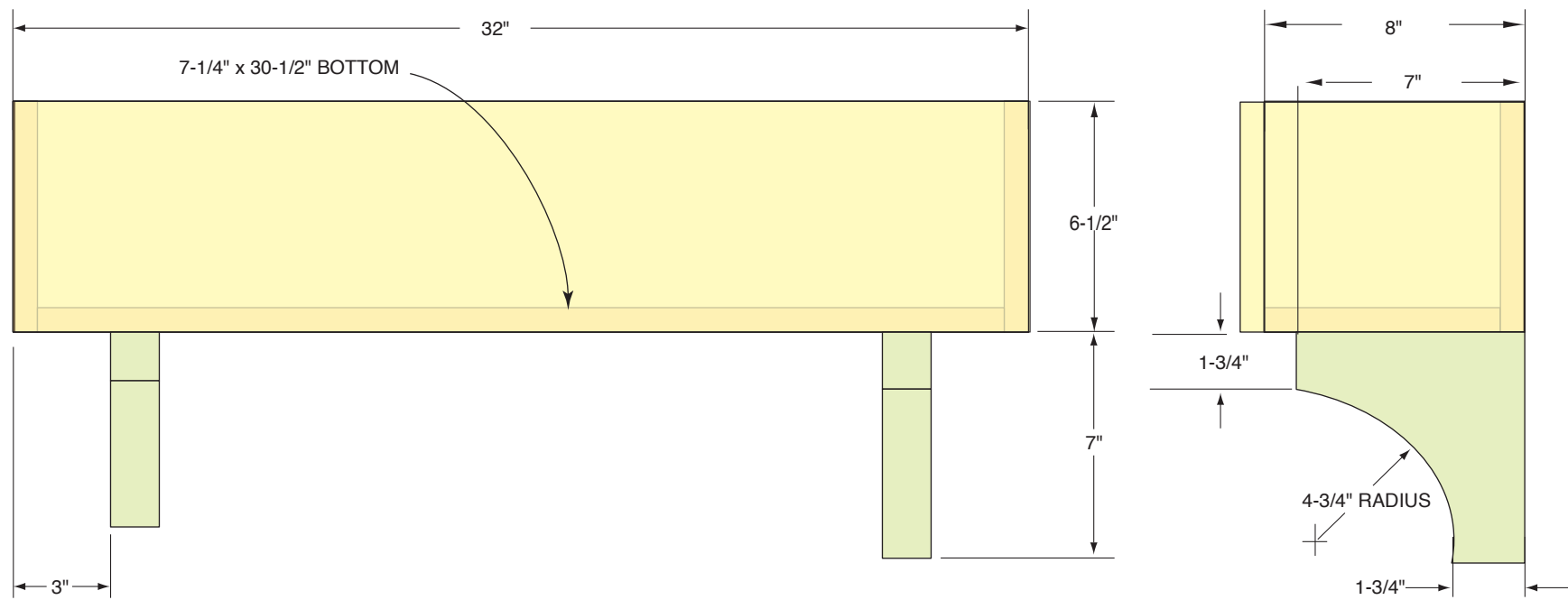

NOTE: BOX (YELLOW PIECES) MADE WITH 3/4" WOOD;
BRACKETS (GREEN PIECES) MADE WITH 1-1/2" WOOD.